

Congratulations

on your purchase of a new

Steel Replacement Door System

Manufactured by Winchester Industries

To maintain your doors brilliant finish and continued operational ease of hardware please follow the Care and Maintenance Instructions below:

1. Door Finish -

Cleaning: Do not clean door for at least 14 days after installation. Use a hot water and mild soap solution. Do not use strong cleaning agents, solvents or abrasives, as they will cause fading, staining or scratching. The door may be waxed with a car wax after 90 days if desired.

Scratches: In the event of a scratch in the painted door, clean surface and apply the touch-up paint provided. If a stained door becomes scratched, apply a matching marker or shoe polish and rub in to match the door.

2. Glass -

Use household glass cleaner with a soft clean cloth.

3. Lock Function -

Locksets: May have to be tightened occasionally and lubricated with WD-40 or a similar product. Should a problem arise, contact a qualified locksmith. Wax brass finish to deter tarnishing.

4. Caution -

Although we use high-temp trim, using a storm door could cause excessive "heat build-up" that will cause the trim to warp. Elimination or ventilation of storm doors is highly suggested.

5. Internal Blinds - If applicable - See reverse side for internal blind operating and maintaining instructions.

The following important steps apply if you purchased doors with internal operating blinds.

RAISE & LOWER BLINDS BETWEEN DOORGLASS

HOMEOWNER INFORMATION



- No dusting
- No exposed cords
- Easy fingertip control
- Increased energy efficiency
- Passes the toughest performance standards
- Tempered glass for safety



CARE & USE INSTRUCTIONS

Integral blinds provide privacy and light control with ultimate convenience. You never have to dust the blinds because they are sealed between tempered safety glass.

To ensure years of smooth, easy operation of your blinds, follow these simple instructions:

- Slide the operator up and down to position the blind to the desired height. If your blinds have a separate tilt control (at the top of the blind), slide it sideways to tilt the slats to the desired angle. If your blinds have a single operator, tilt the blind by slightly sliding the operator up or down.
- For ease of operation, ensure the glass surface is clean. Dirty glass can impede operator movement, thus requiring more force to operate the blinds.
- The blind raises and lowers through use of magnets. If the operator comes loose from the glass so that you are unable to operate the blind, it means the operator magnets have become disengaged. If your operator becomes disengaged, it's easy to correct - just slide the operator all the way to the top of the unit to re-engage it (see diagrams).



Half Doorlite



Full Doorlite

1. Slide the operator past the half-engagement point; you'll hear/feel one click (diagram A).
2. Continue sliding the operator to the very top for full engagement; you'll hear/feel a second click (diagram B).

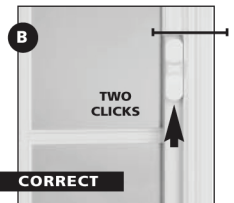
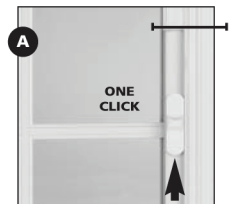

Important: You must slide the operator to the very top (two clicks) to re-engage the magnets.

- If blind bottom rail becomes out-of-level, raise the blinds to the fully open position and then fully lower them. Repeat if necessary. The blinds will adjust themselves back to level.

Sold Exclusively By Authorized Winchester Industries Bristol or Oxford Dealers.